

## TYPE: PE/SB/S1

**Product** 4-cup design

**Group** Separation, batching and displacement

**PE/SB/S1** pigs size 4" – 8" are designed for product separation, batching and displacement operations.

**PE/SB/S1** pigs are manufactured with a steel welded body single bolt design, polyurethane spacers, protection nose and a hoisting facility in front.

**PE/SB/S1** pigs are fitted with 4 standard polyurethane scraper cups which are easily replaceable and create a perfect seal.

### General function and application

Removal of debris, liquid evacuation, product separation, batching and displacement.

**PE/SB/S1** pigs are designed for passing 1.5 D radius bends and will traverse full-size branch openings.

### PE/SB/S1 options available

- Gauging plate aluminium

Size Nom. (inches)	L (mm)	T (mm)	P (mm)
4	175	150	70
6	215	190	90
8	305	270	130

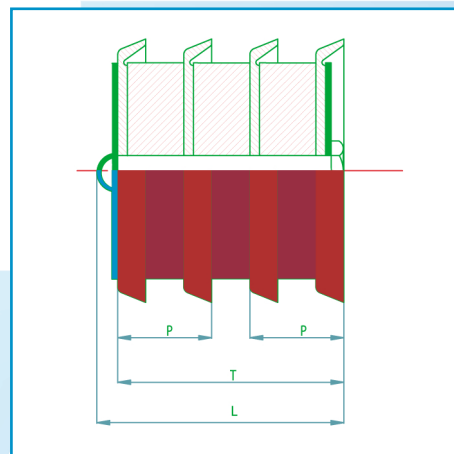

## TYPE: PEMB/S2-1

**Product** 4-cup design

**Group** Separation, batching and displacement

**PE/MB/S2-1** pigs size 10" – 14" are designed for product separation, batching and displacement operations.

**PE/MB/S2-1** pigs are manufactured with a steel welded body multi bolt design, polyurethane spacers, protection nose and a hoisting facility in front.

**PE/MB/S2-1** pigs are fitted with 4 standard polyurethane scraper cups (2 in front and 2 at back) which are easily replaceable and create a perfect seal.

### General function and application

Removal of debris, liquid evacuation, product separation, batching and displacement.

**PE/MB/S2-1** pigs are designed for passing 1.5 D radius bends and will traverse full-size branch openings.

### PE/MB-S2-1 options available

- Gauging plate aluminium
- By pass plugs
- Pig locator cavity

Size Nom. (inches)	L (mm)	T (mm)	P (mm)
10	410	380	150
12	460	430	150
14	510	480	150

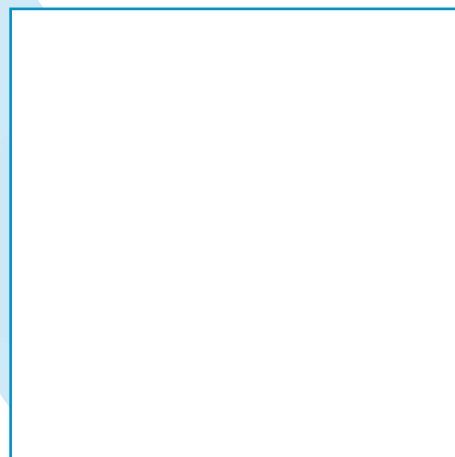
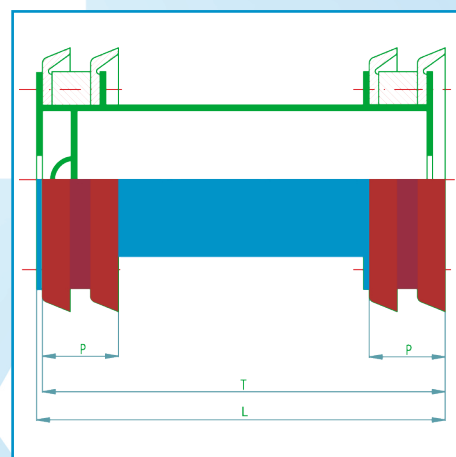

## TYPE: PE/MB/S2-2

**Product** 4-cup design

**Group** Separation, batching and displacement

**PE/MB/S2-2** pigs size 16" – 56" are designed for product separation, batching and displacement operations.

**PE/MB/S2-2** pigs are manufactured with a steel welded body multi bolt design, polyurethane spacers, protection nose and a hoisting facility in front.

**PE/MB/S2-2** pigs are fitted with 4 standard polyurethane scraper cups (2 in front and 2 at back) which are easily replaceable and create a perfect seal.

### General function and application

Removal of debris, liquid evacuation, product separation, batching and displacement.

**PE/MB/S2-2** pigs are designed for passing 1.5 D radius bends and will traverse full-size branch openings.

### PE/MB/S2-2 options available

- Gauging plate aluminium
- By pass plugs
- Pig locator cavity

Size Nom. (inches)	L (mm)	T (mm)	P (mm)
16	580	560	165
18	630	610	165
20	680	660	195
22	730	710	195
24	810	790	195
26	920	900	210
28	1060	1040	210
30	1100	1080	210
32	1120	1100	210
34	1130	1110	210
36	1150	1130	250
38	1210	1190	280
40	1290	1270	280
42	1350	1330	280
48	1540	1520	280
56	1840	1810	320

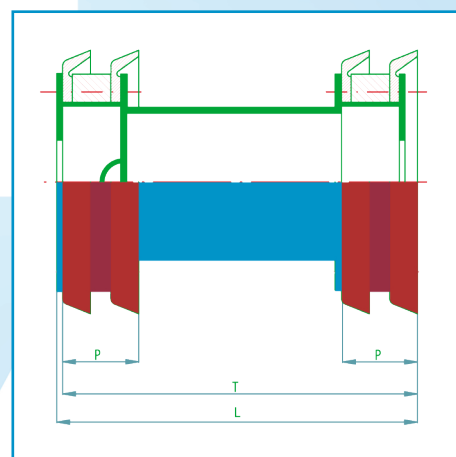

## TYPE: PE/SB/G1

**Product** 2-cup design

**Group** Gauging

**PE/SB/G1** pigs size 4" – 8" are designed to indicate obstructions, proving the roundness of pipelines.

**PE/SB/G1** pigs are manufactured with a steel welded body single bolt design, polyurethane spacers, protection nose and a hoisting facility in front.

**PE/SB/G1** pigs are fitted with 2 standard polyurethane scraper cups which are easily replaceable, and create a perfect seal.

**PE/SB/G1** pigs are equipped with 1 aluminium gauging plate (solid or slotted) in front which is as the cups easily replaceable.

### General function and application

Indicate obstructions, proving the roundness of pipelines and / or removal of construction debris.

**PE/SB/G1** pigs are designed for passing 1.5 D radius bends and will traverse full-size branch openings.

### PE/SB/G1 options available

- 2nd gauging plate

Size Nom. (inches)	L (mm)	T1 (mm)	T2 (mm)
4	161	136	130
6	231	206	200
8	276	241	235

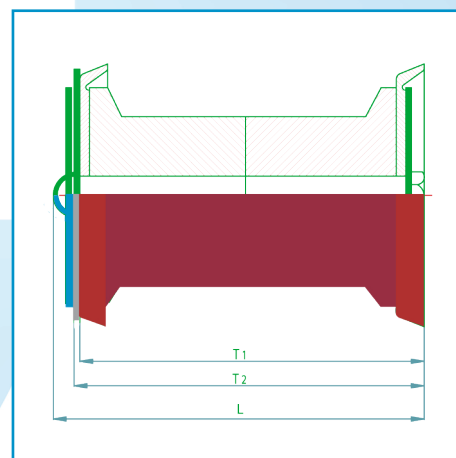

## TYPE: PEMB/G2

**Product** 2-cup design

**Group** Gauging

**PEMB/G2** pigs size 10" – 36" are designed to indicate obstructions, proving the roundness of pipelines.

**PEMB/G2** pigs are manufactured with a steel welded body multi bolt design, protection nose and a hoisting facility in front.

**PEMB/G2** pigs are fitted with 2 standard polyurethane scraper cups which are easily replaceable, and create a perfect seal.

**PEMB/G2** pigs are equipped with 1 aluminium gauging plate (solid or slotted) in front which is as the cups easily replaceable.

### General function and application

Indicate obstructions, proving the roundness of pipelines and /or removal of construction debris.

**PEMB/G2** pigs are designed for passing 1.5 D radius bends and will traverse full-size branch openings.

### PEMB/G2 options available

- By pass plugs
- Pig locator cavity

Size Nom. (inches)	L (mm)	T2 (mm)	T1 (mm)
10	358	338	330
12	458	438	430
14	488	468	460
16	588	568	560
18	638	618	610
20	688	668	660
22	738	718	710
24	818	798	790
26	928	908	900
28	1068	1048	1040
30	1108	1088	1080
32	1128	1108	1100
34	1138	1118	1110
36	1158	1138	1130

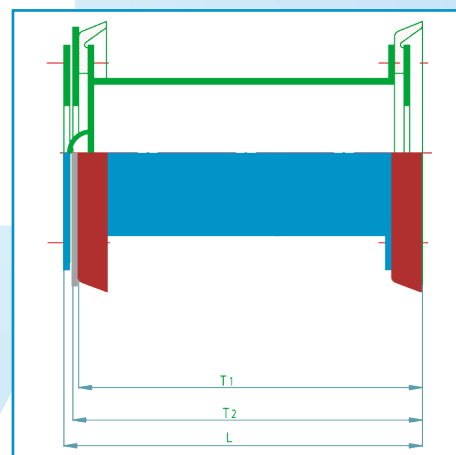

## TYPE: PEMB/G3

**Product** 3-cup design

**Group** Gauging

**PEMB/G3** pigs size 16" – 56" are designed to indicate obstructions, proving the roundness of pipelines.

**PEMB/G3** pigs are manufactured with a steel welded body multi bolt design, polyurethane spacer, protection nose and a hoisting facility in front.

**PEMB/G3** pigs are fitted with 3 standard polyurethane scraper cups (2 in front and 1 at back) which are easily replaceable, and create a perfect seal.

**PEMB/G3** pigs are equipped with 1 aluminium gauging plate (solid or slotted) in front, which is as the cups easily replaceable.

### General function and application

Indicate obstructions, proving the roundness of pipelines and / or removal of construction debris.

**PEMB/G3** pigs are designed for passing 1.5 D radius bends and will traverse full-size branch openings.

### PEMB/G3 options available

- By pass plugs
- Pig locator cavity

Size Nom. (inches)	L (mm)	T2 (mm)	T1(mm)	P (mm)
16	588	568	560	165
18	638	618	610	165
20	688	668	660	195
22	738	718	710	195
24	818	798	790	195
26	928	908	900	210
28	1068	1048	1040	210
30	1108	1088	1080	210
32	1128	1108	1100	210
34	1138	1118	1110	210
36	1158	1138	1130	250
38	1218	1198	1190	280
40	1298	1278	1270	280
42	1358	1338	1330	280
48	1548	1528	1520	280
56	1848	1818	1810	320

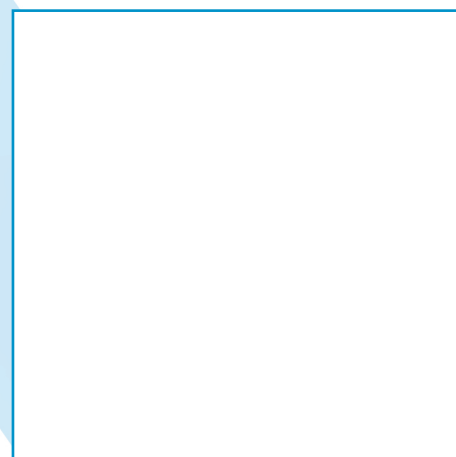
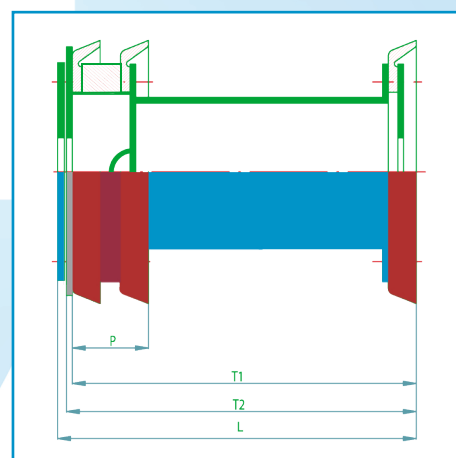

## TYPE: PE/SB/C1-1

**Product** 2-cup design

**Group** Cleaning

**PE/SB/C1-1** pigs size 4" –14" are designed for removal of deposits from the inner pipe wall and / or construction debris.

**PE/SB/C1-1** pigs are manufactured with a steel welded body single bolt design, polyurethane spacers, protection nose and a hoisting facility in front.

**PE/SB/C1-1** pigs are fitted with 2 standard polyurethane scraper cups which are easily replaceable and create a perfect seal.

**PE/SB/C1-1** pigs are equipped with 2 circular steel wire crimped brushes which are as the cups easily replaceable.

### General function and application

Removal of deposits from the inner pipe wall and / or construction debris.

**PE/SB/C1-1** pigs are designed for passing 1.5 D radius bends and will traverse full-size branch openings.

### PE/SB/C1-1 options available

- Brushes stainless steel
- Brushes nylon
- Gauging plate aluminium
- Studded discs

Size Nom. (inches)	L (mm)	T2 (mm)	T1(mm)	P(mm)
4	176	151	123	58
6	211	186	153	73
8	291	256	218	98
10	359	324	286	103
12	425	390	347	108
14	489	454	411	108

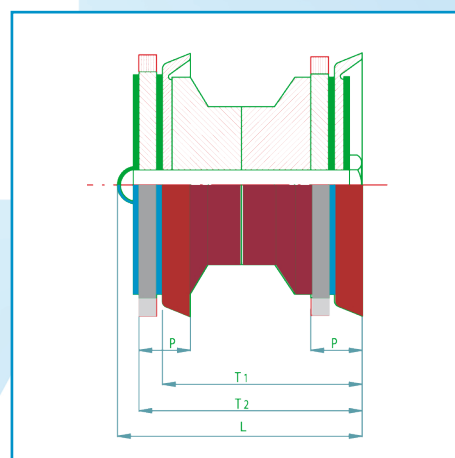



## TYPE: PEMB/C1-2

**Product** 2-cup design

**Group** Cleaning

**PEMB/C1-2** pigs size 16" –56" are designed for removal of deposits from the inner pipe wall and / or construction debris.

**PEMB/C1-2** pigs are manufactured with a steel welded body multi bolt design, polyurethane spacers, protection nose and a hoisting facility in front.

**PEMB/C1-2** pigs are fitted with 2 standard polyurethane scraper cups which are easily replaceable and create a perfect seal.

**PEMB/C1-2** pigs are equipped with 2 circular steel wire crimped brushes which are as the cups easily replaceable.

### General function and application

Removal of deposits from the inner pipe wall and / or construction debris.

**PEMB/C1-2** pigs are designed for passing 1.5 D radius bends and will traverse full-size branch openings.

### PEMB/C1-2 options available

- Brushes stainless steel
- Brushes nylon
- By pass plugs
- Pig locator cavity
- Magnets
- Studded discs

Size Nom. (inches)	L (mm)	T2 (mm)	T1(mm)	P(mm)
16	588	568	493	145
18	638	618	543	145
20	688	668	578	175
22	738	718	628	175
24	818	798	708	175
26	928	908	813	185
28	1068	1048	953	185
30	1108	1088	993	185
32	1128	1108	1013	185
34	1138	1118	1023	185
36	1158	1138	1028	220
38	1218	1198	1068	250
40	1298	1278	1148	250
42	1358	1338	1208	250
48	1548	1528	1398	250
56	1848	1818	1678	280

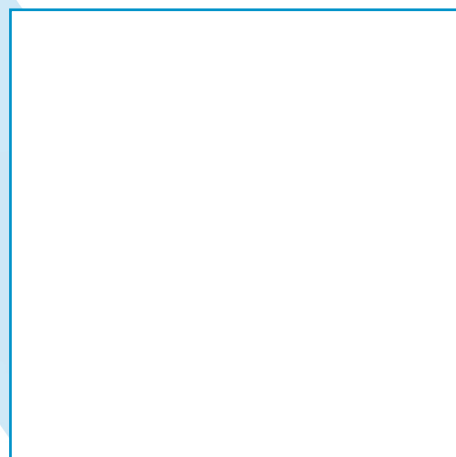
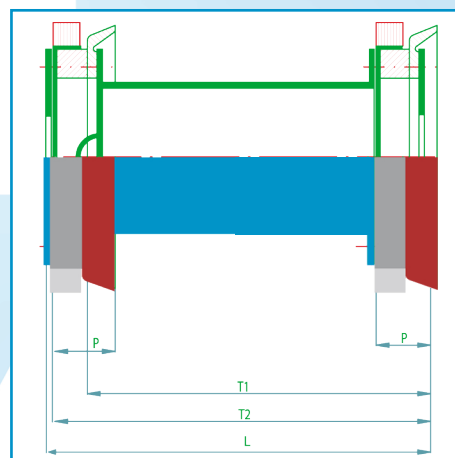



## TYPE: PE/MB/C2

**Product** 2-cup design

**Group** Cleaning

**PE/MB/C2** pigs size 10" – 36" are designed for removal of deposits from the inner pipe wall and / or construction debris.

**PE/MB/C2** pigs are manufactured with a steel welded body multi bolt design, protection nose and a hoisting facility in front.

**PE/MB/C2** pigs are fitted with 2 standard polyurethane scraper cups which are easily replaceable and create a perfect seal.

**PE/MB/C2** pigs are equipped with 1 set spring loaded block type brushes (Brush pins made of stainless steel) which cover 360° inside pipe wall under all pigging conditions and are as the cups easily replaceable.

### General function and application

Removal of deposits from the inner pipe wall and / or construction debris.

**PE/MB/C2** pigs are designed for passing 1.5 D radius bends and will traverse full-size branch openings.

### PE/MB/C2 options available

- Brushes triangle type
- Brushes nylon
- Polyurethane 3-rib wax scrapers
- Gauging plate aluminium
- By pass plugs
- Pig locator cavity
- Magnets

Size Nom. (inches)	L (mm)	T (mm)	No. Brushes
10	350	330	6
12	450	430	6
14	480	460	6
16	580	560	6
18	630	610	6
20	680	660	8
22	730	710	8
24	810	790	10
26	920	900	10
28	1060	1040	12
30	1100	1080	12
32	1120	1100	14
34	1130	1110	14
36	1150	1130	14

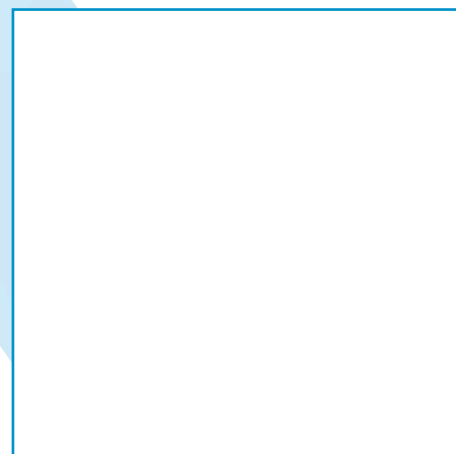
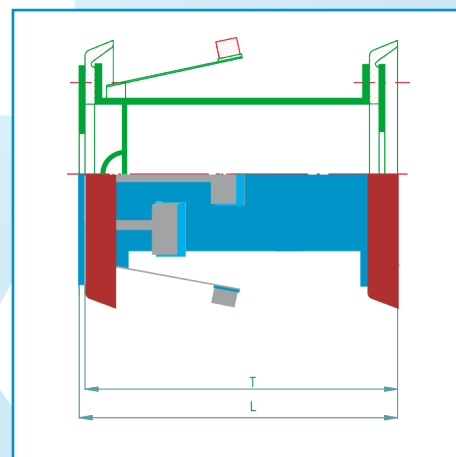

## TYPE: PE/MB/C3

**Product** 3-cup design

**Group** Cleaning

**PE/MB/C3** pigs size 24" –56" are designed for removal of deposits from the inner pipe wall and / or construction debris.

**PE/MB/C3** pigs are manufactured with a steel welded body multi bolt design, polyurethane spacer, protection nose and a hoisting facility in front.

**PE/MB/C3** pigs are fitted with 3 standard polyurethane scraper cups (2 in front and 1 at back) which are easily replaceable and create a perfect seal.

**PE/MB/C3** pigs are equipped with 1 set spring loaded block type brushes (Brush pins made of stainless steel) which cover 360° inside pipe wall under all pigging conditions and are as the cups easily replaceable.

### General function and application

Removal of deposits from the inner pipe wall and / or construction debris.

**PE/MB/C3** pigs are designed for passing 1.5 D radius bends and will traverse full-size branch openings.

### PE/MB/C3 options available

- Brushes triangle type
- Brushes nylon
- Polyurethane 3-rib wax scrapers
- Gauging plate aluminium
- By pass plugs
- Pig locator cavity
- Magnets

Size Nom. (inches)	L (mm)	T (mm)	P(mm)	No. brushes
24	810	790	195	10
26	920	900	210	10
28	1060	1040	210	12
30	1100	1080	210	12
32	1120	1100	210	14
34	1130	1110	210	14
36	1150	1130	250	14
38	1210	1190	280	16
40	1290	1270	280	16
42	1350	1330	280	18
48	1540	1520	280	20
56	1840	1810	320	24

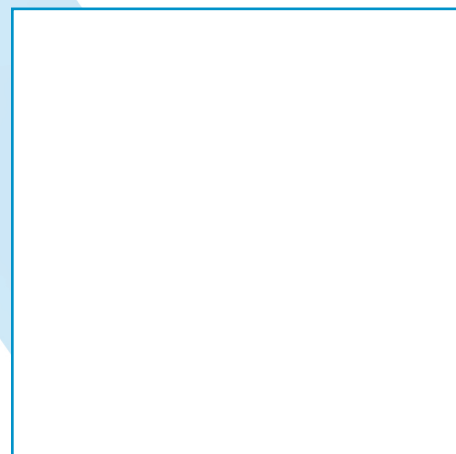
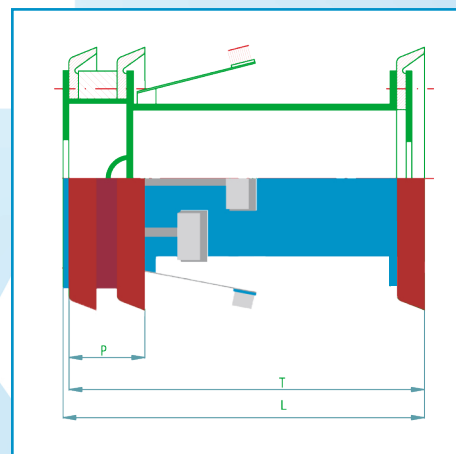

## TYPE: PE/MB/C4

**Product** 4-cup design

**Group** Cleaning

**PE/MB/C4** pigs size 32" – 56" are designed for removal of deposits from the inner pipe wall and / or construction debris.

**PE/MB/C4** pigs are manufactured with a steel welded body multi bolt design, polyurethane spacers, protection nose and a hoisting facility in front.

**PE/MB/C4** pigs are fitted with 4 standard polyurethane scraper cups (2 in front and 2 at back) which are easily replaceable and create a perfect seal.

**PE/MB/C4** pigs are equipped with 1 set spring loaded block type brushes (Brush pins made of stainless steel) which cover 360° inside pipe wall under all pigging conditions and are as the cups easily replaceable.

### General function and application

Removal of deposits from the inner pipe wall and / or construction debris.

**PE/MB/C4** pigs are designed for passing 1.5 D radius bends and will traverse full-size branch openings.

### PE/MB/C4 options available

- Brushes triangle type
- Brushes nylon
- Polyurethane 3-rib wax scrapers
- Gauging plate
- By pass plugs
- Pig locator cavity
- Magnets

Size Nom. (inches)	L (mm)	T (mm)	P(mm)	No. brushes
32	1120	1100	210	14
34	1130	1110	210	14
36	1150	1130	250	14
38	1210	1190	280	16
40	1290	1270	280	16
42	1350	1330	280	18
48	1540	1520	280	20
56	1830	1810	320	24

